

Note: Some designs in this collection may have been created using unique special stitches and/or techniques. To preserve design integrity when rescaling or rotating designs in your software, always rescale or rotate designs using the handles directly on-screen.

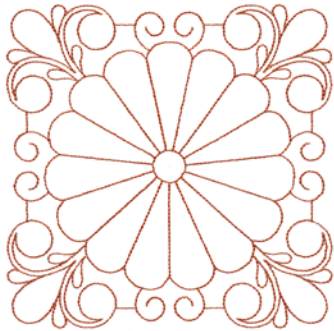

12521-01 Daisy Square 1
4.86 X 4.86 in.
123.44 X 123.44 mm
6,998 St. ✿

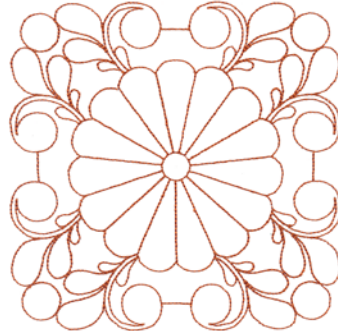

12521-02 Daisy Square 2
4.88 X 4.88 in.
123.95 X 123.95 mm
7,370 St. ✿

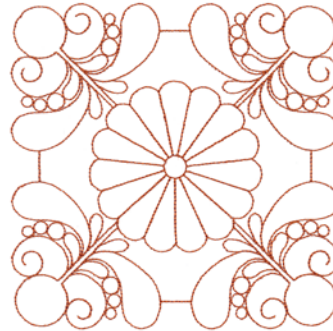

12521-03 Daisy Square 3
4.86 X 4.86 in.
123.44 X 123.44 mm
7,320 St. ✿

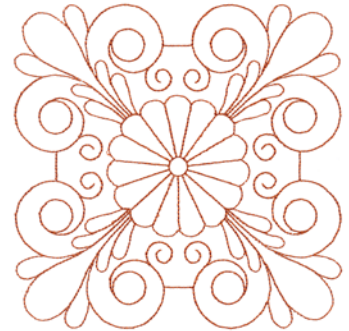

12521-04 Daisy Square 4
4.84 X 4.84 in.
122.94 X 122.94 mm
7,505 St. ✿

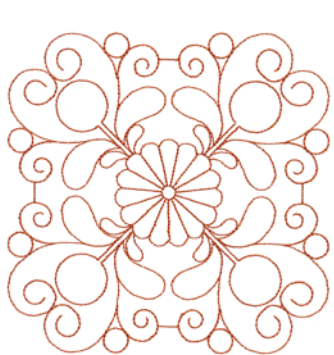

12521-05 Daisy Square 5
4.86 X 4.86 in.
123.44 X 123.44 mm
6,905 St. ✿



12521-06 Quilting Daisy 1
4.36 X 4.90 in.
110.74 X 124.46 mm
4,165 St. ✿



12521-07 Quilting Daisy 2
3.76 X 5.15 in.
95.50 X 130.81 mm
4,017 St. ✿ L



12521-08 Quilting Daisy 3
4.78 X 5.41 in.
121.41 X 137.41 mm
5,988 St. ✿ L

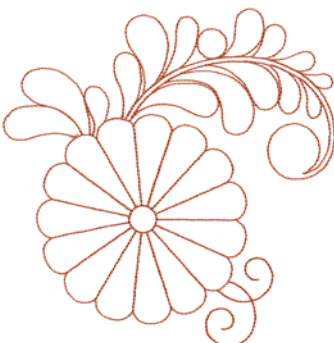

12521-09 Quilting Daisy 4
4.97 X 5.08 in.
126.24 X 129.03 mm
4,724 St. ✿ L

✿ Design contains a loose fill.

✿ Some solid areas shown are not stitched.

L Design is larger than 5" (127 mm) in either direction.

S Design is smaller than 1.5" (38.1 mm) in either direction.

It is a violation of Copyright law to make and distribute copies of electronic designs or artwork.

Electronic designs are licensed to the original purchaser for use at one location. ©2014 OESD, LLC. All rights reserved.



Quilting Feather Daisies

#12521 / 9 Designs

Listings below indicate color sample, stitching order and suggested thread color number. "I" refers to Isacord thread and "T" refers to Timeless thread. Colors beginning with 20501 refer to YLI Fine Metallics, 7 refer to Yenmet Metallic, 8 refer to YLI Variations Variegated Thread and 9 refer to Isacord Multicolor Variegated.

	I	T		I	T		I	T
12521-01 Daisy Square 1			12521-04 Daisy Square 4			12521-07 Quilting Daisy 2		
1. Single Color Design	1311	24127	1. Single Color Design	1311	24127	1. Single Color Design	1311	24127
12521-02 Daisy Square 2			12521-05 Daisy Square 5			12521-08 Quilting Daisy 3		
1. Single Color Design	1311	24127	1. Single Color Design	1311	24127	1. Single Color Design	1311	24127
12521-03 Daisy Square 3			12521-06 Quilting Daisy 1			12521-09 Quilting Daisy 4		
1. Single Color Design	1311	24127	1. Single Color Design	1311	24127	1. Single Color Design	1311	24127



Create a quick small wallhanging showcasing OESD Quilting Feather Daisies #12521 embroidery collection. This collection features 9 different outline quilting daisy designs. Use the embroidery designs to “quilt” the wallhanging. It is simple and fun.

Supplies:

- OESD embroidery collection Quilting Feather Daisies #12521
- 1 yd. fabric (front center, back and binding)
- ¼ yd. print fabric (borders)
- ⅓ yd. or 24" square cotton batting
- Embroidery threads
- Temporary spray adhesive or curved safety pins
- Double sided fabric tape
- Fabric marking pen
- Walking foot

NOTE: The yardage allows for (9) 5 ½" squares. If you want the squares bigger like 6", then multiply 6" x 3 = 18" + ½" seams = 18 ½" square (front center). Make adjustments for the back and borders also.

Cut:

- (1) 17" square fabric (front center)
- (1) 24" square fabric (back)
- (2) 3 ½" x 23" print fabrics (borders)
- (2) 3 ½" x 17" print fabrics (borders)
- (2) 2 ¼" x 44" fabric (binding)



Prepare for embroidery: ¼" seam allowance

- Right sides together, pin and stitch each 3 ½" x 17" borders to front center. Press seam away from front center. **Photo 1.**
- Right sides together, pin and stitch each 3 ½" x 23" borders to front center. Press seam away from front center. (Quilt top) **Photo 2.**
- Layer a quilt sandwich, by placing back wrong side up, cotton batting, and the quilt top right side up. Use temporary spray adhesive or safety pins to baste the layers together. **Photo 3.**

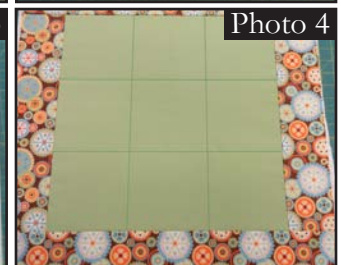

Embroider:

- Divide and mark the front center of the quilt top into 9 squares. Each daisy embroidery design is hooped and stitched into one of the 9 squares, starting in the center. The square daisy embroidery designs are stitched in the center and the four outer corners. The other daisy designs are stitched in the remaining four squares. There is no stabilizer because the thickness of the batting serves as a stabilizer. **Photo 4.**

- Starting with the center square, find and mark the center. Place double sided fabric tape on the wrong side of the inner hoop. Using template in inner hoop, position onto center mark on center square, and hoop. Place hoop on the embroidery machine and find center point. **Photo 5.** Stitch embroidery design. Remove hoop. **Photo 6.**
- Repeat the process of finding center mark, hooping, and stitching the next embroidery design until all the squares are completely stitched. **Photo 7.**

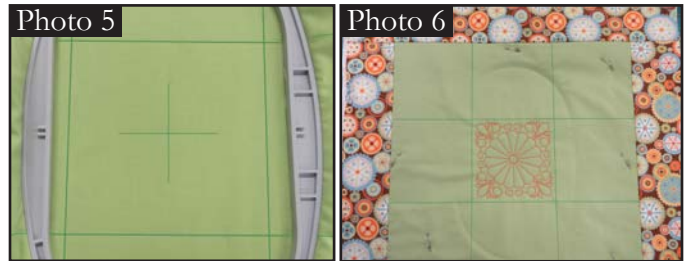

Assembly:

- Using walking foot, stitch along straight lines that were created to divide quilt into squares. Quilt the borders as desired. **Photo 8.**
- Square up the quilt, this is trimming the quilt until the sides are equal. This prepares the quilt for stitching on the binding. **Photo 9.**
- Stitch on the binding as desired.

